

USER OPERATING INSTRUCTIONS

OPERATING THE SHOWER

- When the electricity supply to the shower is switched on at the isolating switch, the red "power" indicator will light under button **A**.

If there is no power light on, please turn on the switch above the ensuite door.

To start the shower

NOTE: the shower starts as a **High heat setting if the Start/Stop button is used.**

Button **A**, **B**, **C** or **D** may be pressed to start the shower.

- Press **A** (Start/Stop) the shower **High** setting automatically.
- Press **B** (Cold water) the shower the **Cold** setting.
- Press **C** (Economy heat) the shower on the **Economy** setting.
- Press **D** (High heat) the shower the **High** setting.

To stop the shower

- The shower can be stopped by pressing the **start/stop** button. When pressed, the phased shutdown will begin and water will cease to flow after a few seconds. When the start/stop button is pressed water will continue to flow in order to remove heated water inside the unit.
- Water will cease to flow after a few seconds.

Cold water setting - blue indicator on

- Cold:** The shower will set to Cold setting does not provide any heat from the heater can to the incoming water.

Economy heat setting - blue indicator on

- Economy:** The shower will set using only one of the elements.

High heat setting - blue indicator on

- High:** The shower will set to Maximum, using both of the elements .

IMPORTANT: it will take a few seconds for the temperature to stabilise once changes have been made.

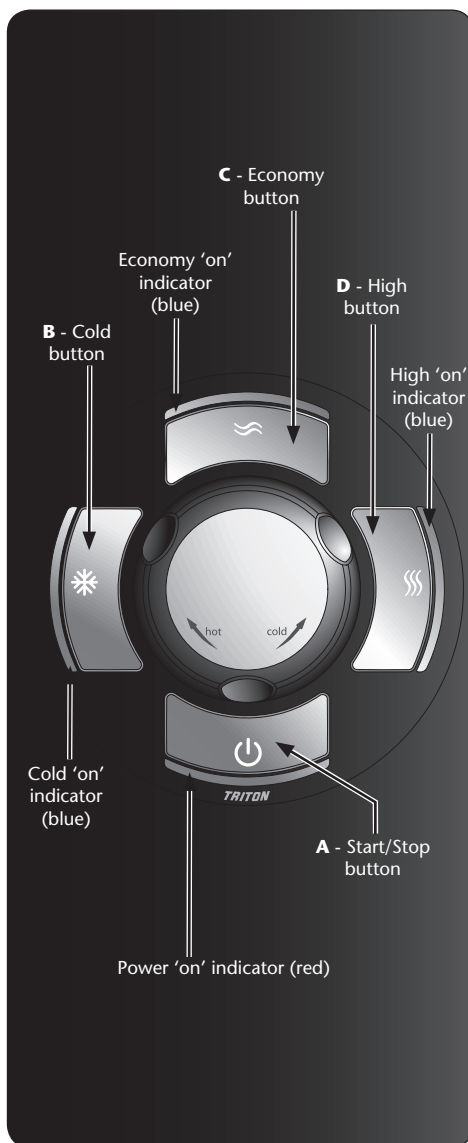

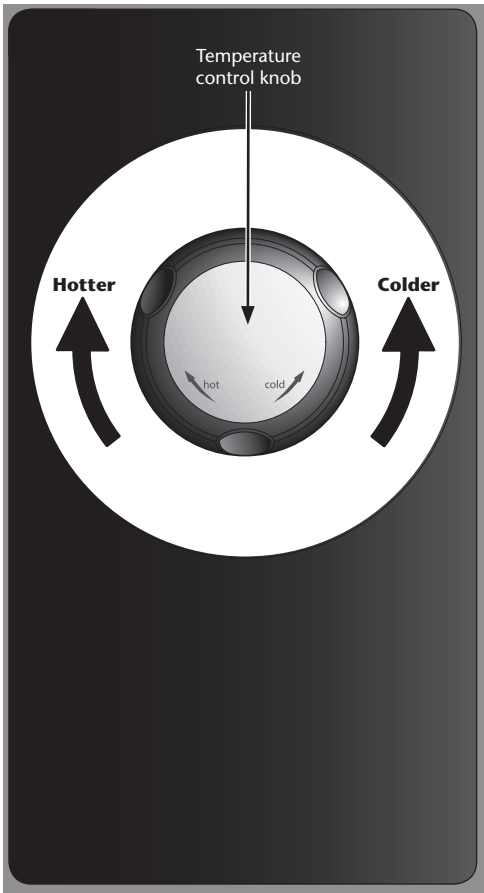

To adjust the shower Economy and High settings only

- The water temperature is altered by increasing or decreasing the flow rate of the water through the shower control.
- After obtaining your showering temperature, the knob can be left as the normal setting and should only need altering to compensate for seasonal changes in ambient water temperature.

NOTE: *The preferred knob position on ECONOMY will give a different temperature to the same position on HIGH.*

To decrease the shower temperature

- Turn the temperature control **anti-clockwise**
 - this will increase the flow of water and make the water **colder**.

To increase the shower temperature

- Turn the temperature control **clockwise** -this will decrease the flow of water and make the water **hotter**.

NOTE: *It is advisable that the showering temperature is satisfactory by testing with your hand before stepping under the showerhead. There will always be a time delay of a few seconds between selecting a flow rate and the water reaching the stable temperature for that flow rate.*